

Department/ Service

Level Elevator (closest to destination)

Acute Cardiac Care Unit (ACCU)24,5	Cardiothoracic Operating Room (CTOR)41,2	Operating Room/ Recovery (OR)44,5	Waiting Rm. Cath Lab28,9
Admitting1	Emergency Department (ED)1	Orthopedic Unit21,2	Waiting Rm. Cardiac48,9
Administration1	Endoscopy/ GI34,5	Pediatrics38,9	Waiting Rm. Endoscopy/ ICU34,5
Ambulatory Surgery Unit (ASU)44,5	Gift Shop1	Pre-Admission Testing (PAT)26,7	Waiting Rm. OR44,5
Cafeteria1	Intensive Care Unit (ICU)34,5	Post Anesthesia Care Unit (PACU)44,5	
Cardiac Testing (CT)24,5	Laboratory1	Post Cardiac Unit (PCU)44,5	
Cardiac Waiting Rm44,5	Medical Library1	Psychiatry28,9	
Cardiac Catheterization Lab (CATH LAB)28,9	Medical Records1	Pulmonary Function Testing (PFT)36,7	
Cashier1	MRI (CMI)1	Radiology1	
Chapel1	Neurologic Surgery38,9	Rehabilitation Services/ OT/ PT/ Speech24,5	
Conference Rooms A,B,C,D1	Nursing Administration1	Special Care Unit (SCU)44,5	
Cardiothoracic Intensive Care (CTICU)48,9	Oncology31,2	Waiting Rm. Radiology1	

Unit/ Room Breakdown

Specialty	Room Number
2A	Psychiatry Unit 203-217
2D	Observation/ Medical/ Surgical 219-230
2C	Acute Cardiac Care Unit 251-260
2E	Orthopedic Unit 261-272
3A	Medical/ Surgical 301-312
3B	Oncology/ Medical/ Surgical 321-337
	Neurology/ Pediatrics Units 350-373
3C	Medical/ Surgical 374-394
CTICU	Cardiothoracic Intensive Care Unit 401-409
4A	Progressive Care Unit 410-413 418-419
4C	Special Care Unit 414-417 420-435
ICU	Intensive Care Unit 3001-3016

Key: Cashier \$ Elevator ■ Entrance ▶ Registration 🖥 Restroom ○ Stairs 🪜 Waiting Room 👤

First Level

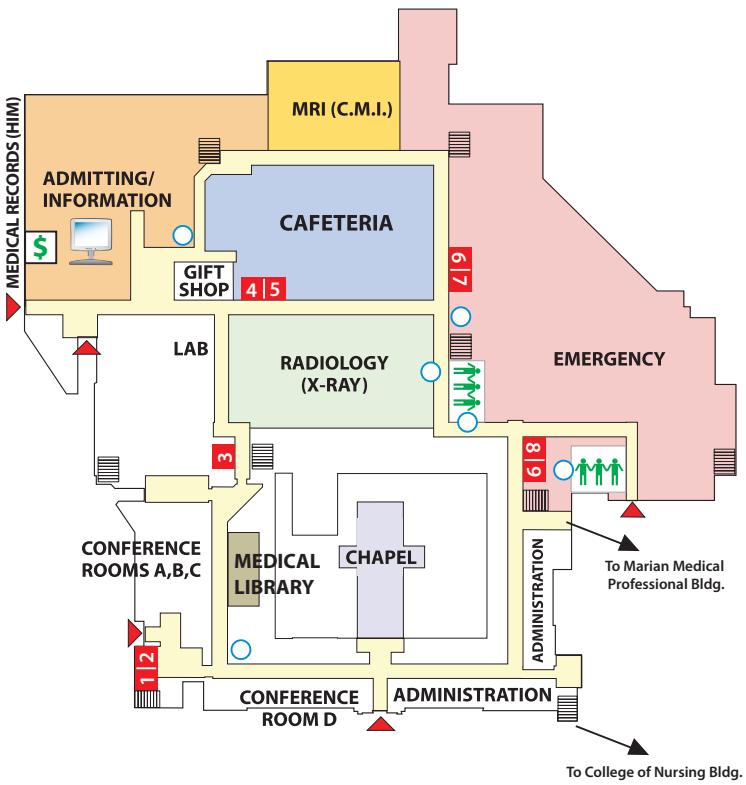

Second Level

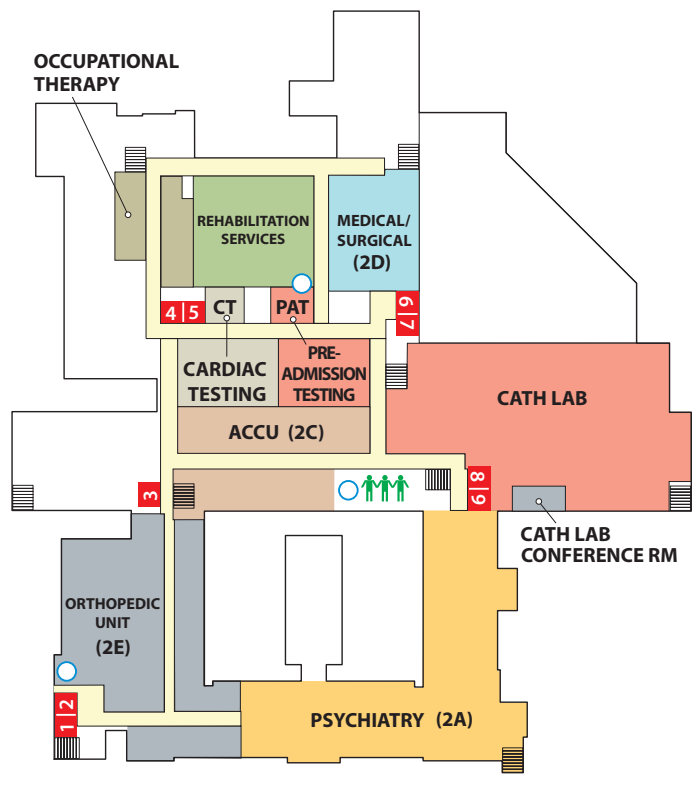

Third Level

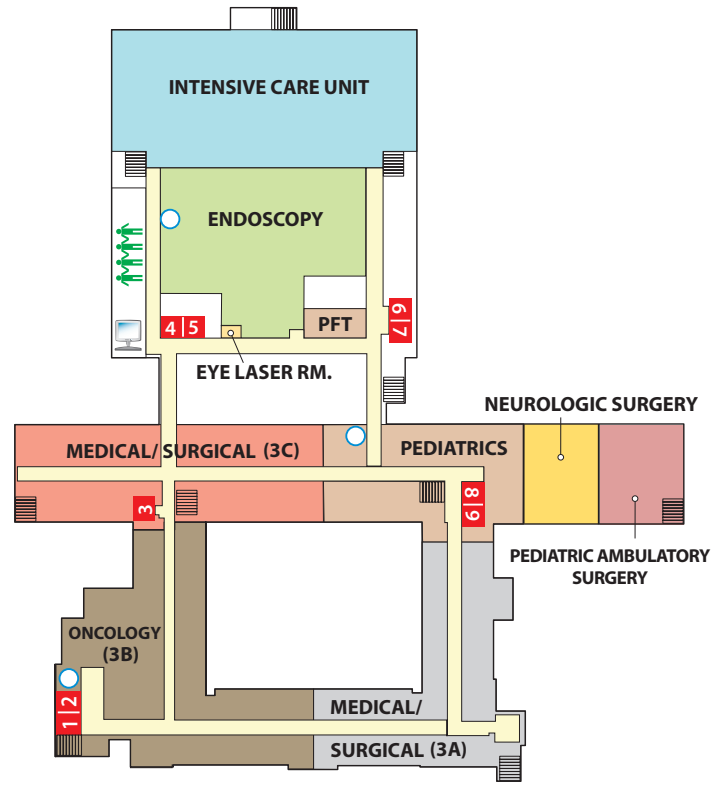

Fourth Level

